

U3

Quick Start Guide



【How To Use GlocalMe Cloud SIM Service?】

(Highly Recommended)

1 Download GlocalMe App

- Download and install GlocalMe app on your mobile phone

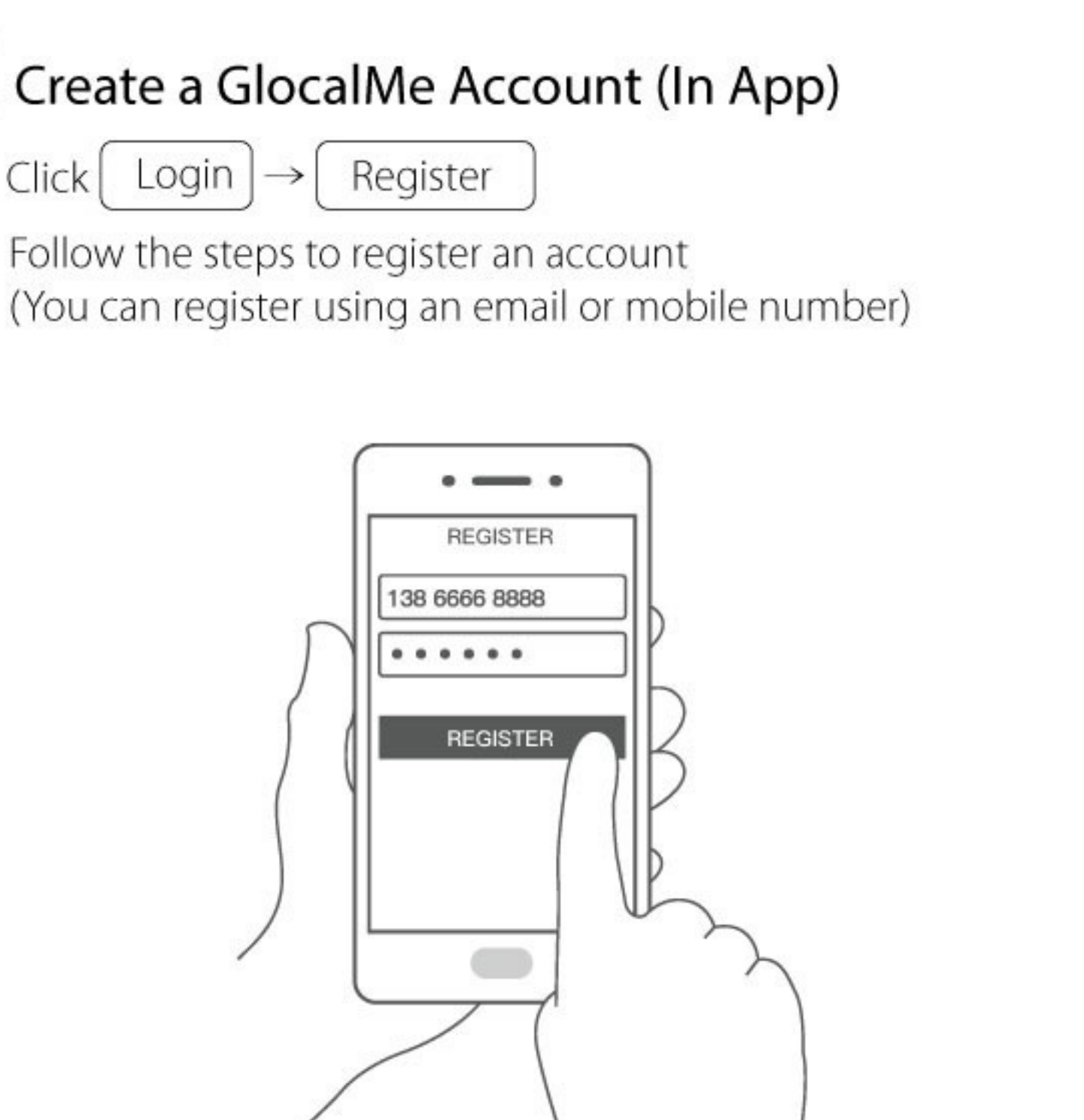

2 Create a GlocalMe Account (In App)

- Click **Login** → **Register**
- Follow the steps to register an account (You can register using an email or mobile number)



3 Purchase In-App GlocalMe Data Plans

- Choose the data plans that suit your needs.(Skip this step if you have already ordered a data plan with the purchase of your device)

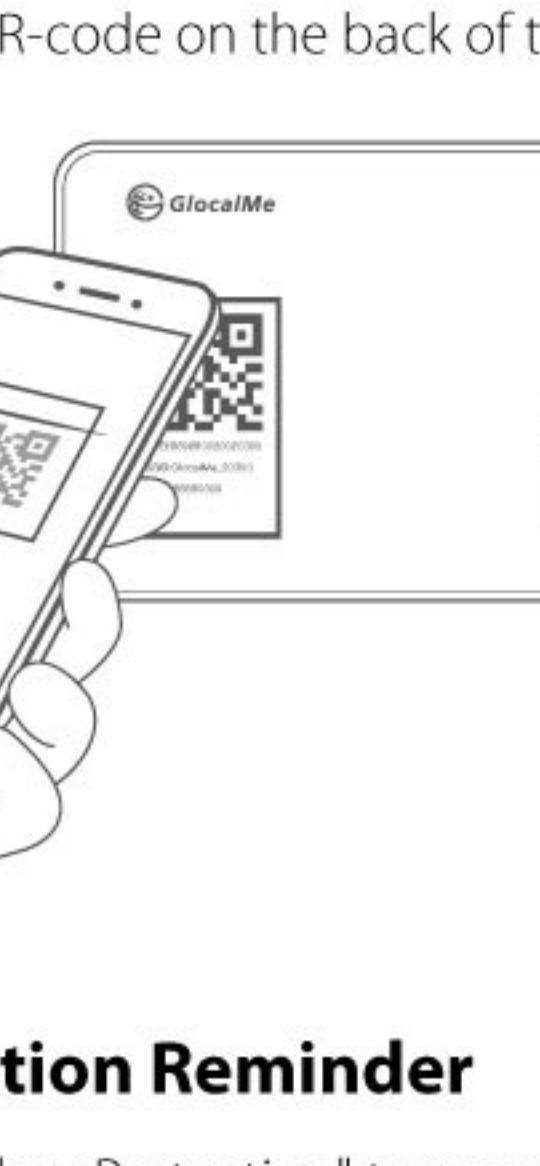

4 Link Device with GlocalMe App

- Open GlocalMe App and click → **My Device** → **Activate Device**
- Scan the device QR-code on the back of the U3 model



Data Flow Protection Reminder

This product has "Data Flow Protection" turns on by default to prevent connected devices from consuming large data due to automatic system and application's updates. While this function is turn on, it might cause you to be restricted of accessing the APP store or unable to download applications. If needed, you can temporarily remove the restriction via visiting 192.168.43.1 in the browser.

5 Turn On U3

- Press and hold the power button for 3 seconds (if you cannot turn on the new U3, please charge the device and wait for device to be fully charged)
- Once the light of stays on, it means your device is ready to connect

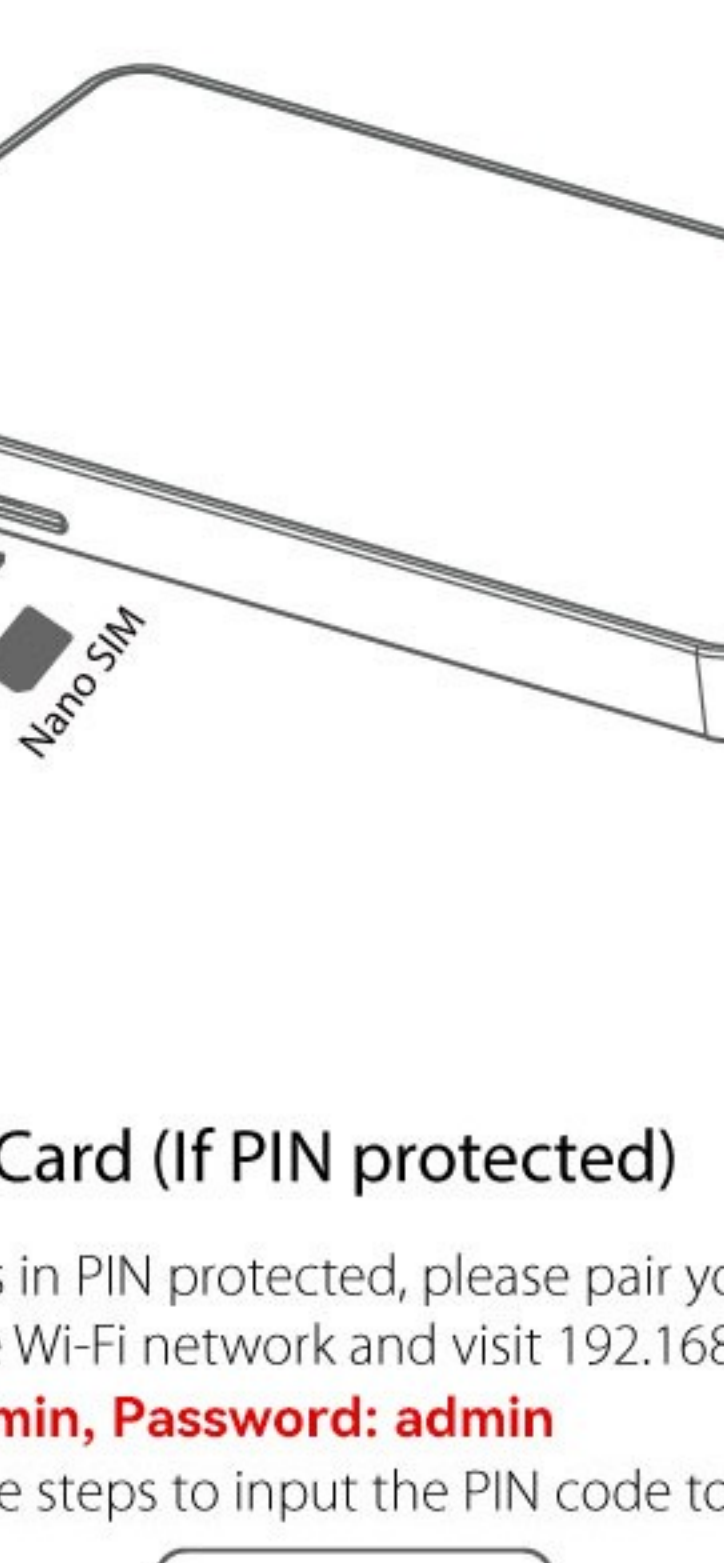

6 Connect To Wi-Fi

- Find the Wi-Fi network name and password at the back of U3
- On your mobile device(s) under Wi-Fi settings search for the network and connect

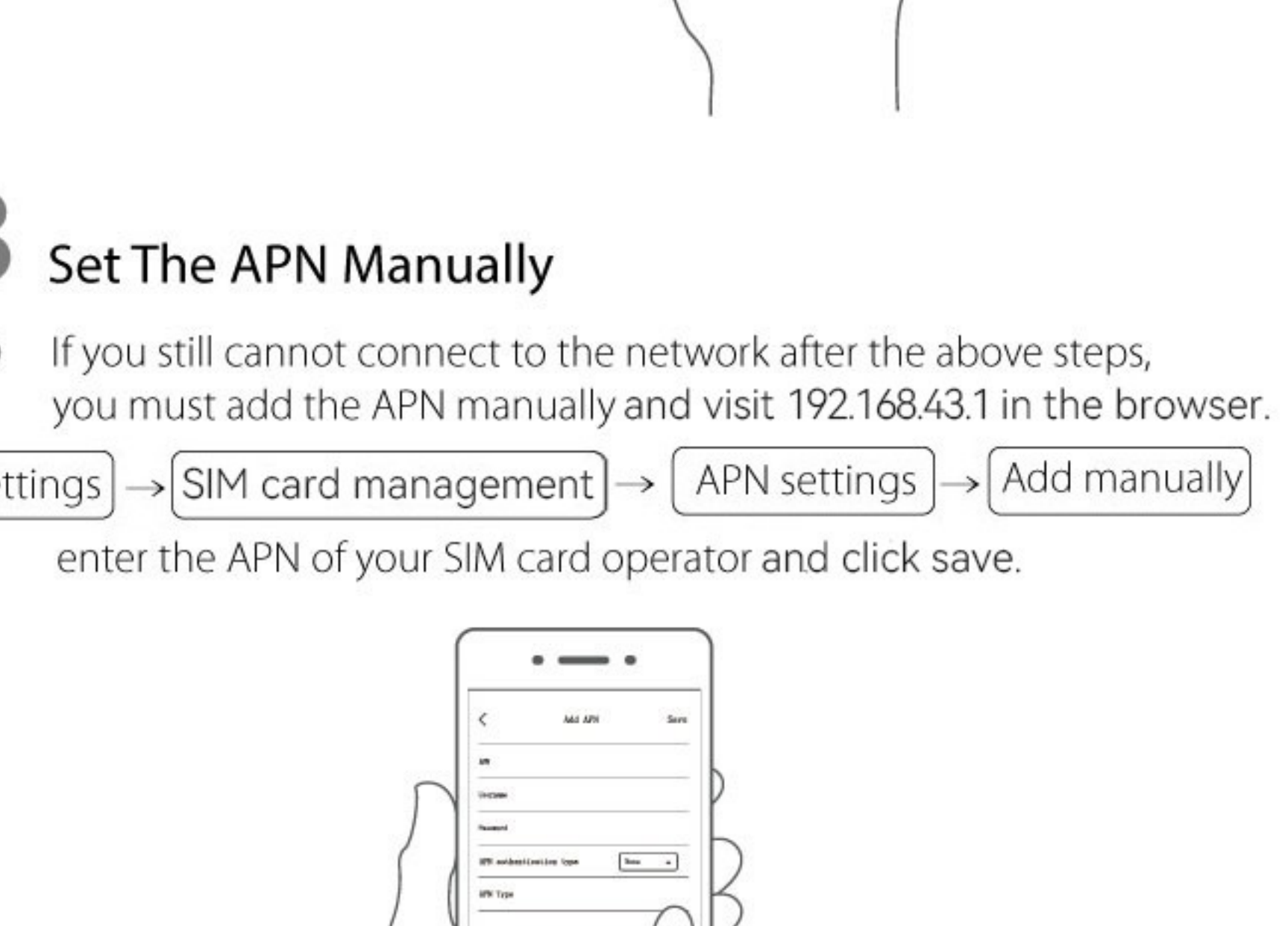

【How To Use A Physical SIM Card?】

(U3 is default to run on Cloud SIM services, but it also supports the use of local SIM cards)

1 Insert The SIM Card

- Please turn off your device when inserting/removing SIM card
- Open the SIM card tray with a pin and insert the SIM card as shown in the picture below.U3 device only supports Nano-SIM cards.

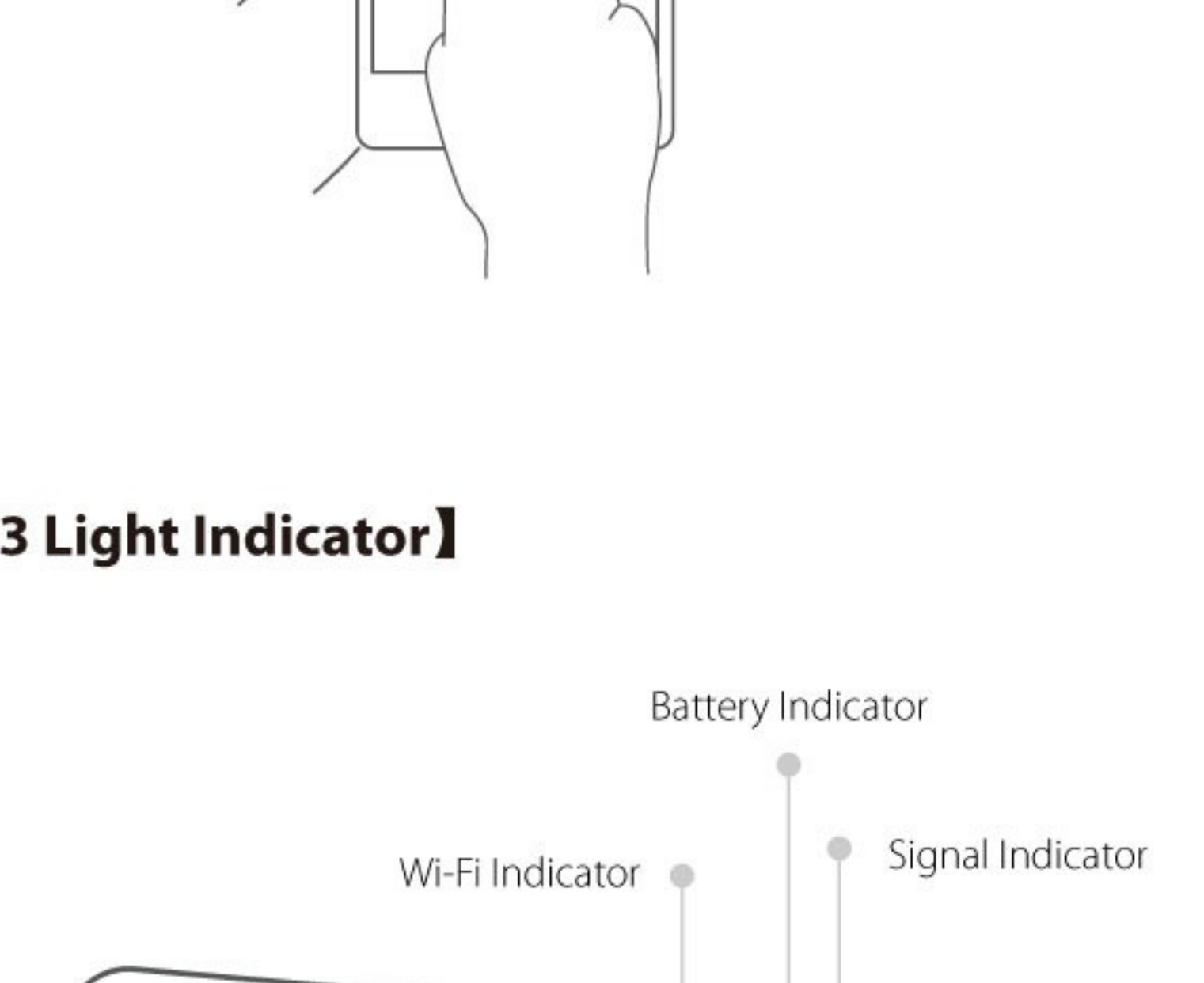

2 Unlock SIM Card (If PIN protected)

- If the SIM card is in PIN protected, please pair your mobile device to the GlocalMe Wi-Fi network and visit 192.168.43.1 in your browser. **Username: admin, Password: admin**
- Please follow the steps to input the PIN code to unlock the SIM

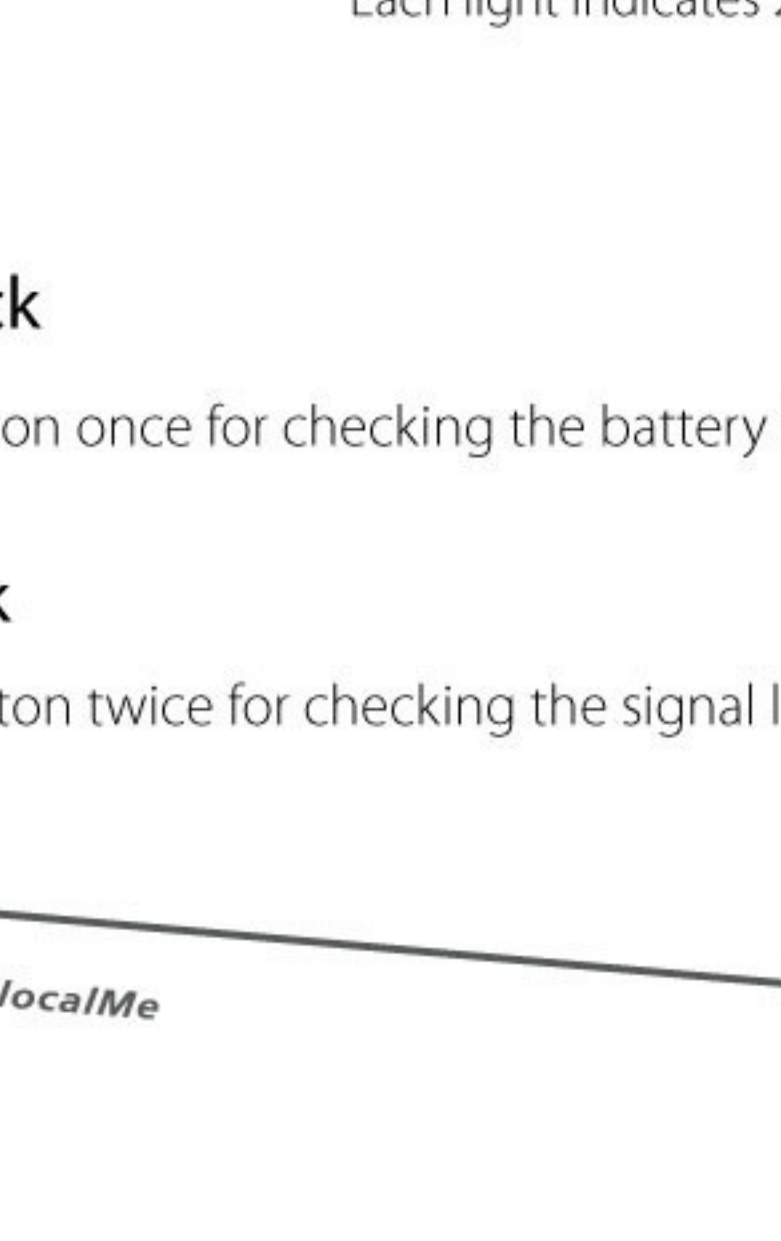

3 Set The APN Manually

- If you still cannot connect to the network after the above steps, you must add the APN manually and visit 192.168.43.1 in the browser.

Settings → **SIM card management** → **APN settings** → **Add manually**

enter the APN of your SIM card operator and click save.



4 SIM Card Selection

- Connect your mobile phone / laptop to GlocalMe Wi-Fi and visit 192.168.43.1 in the browser
- Select [SIM] in the section of SIM Card Selection

【U3 Light Indicator】

1 Battery Check

- Press power button once for checking the battery level

2 Signal Check

- Press power button twice for checking the signal level

Manage My Device

Web: 192.168.43.1
Username: admin
Password: admin