

# U2

Quick Start Guide



## 1 Download GlocalMe APP

- Download and Install GlocalMe App on your mobile



## 2 Register a GlocalMe Account (in APP)

- Press **Login** → **Register**
- Follow the step to register an account (You can register by email or mobile number)

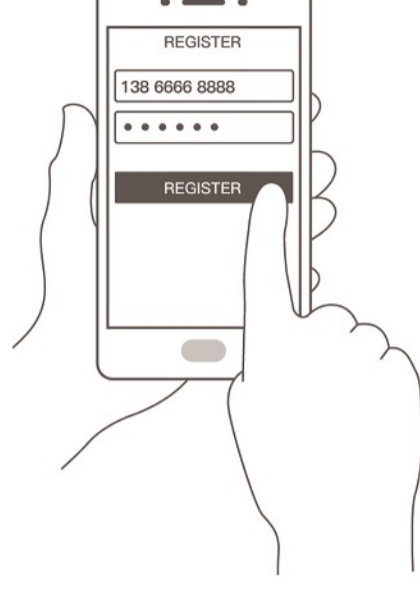

## 3 Turn on U2

- Press and hold the power button for 3 second
- When the light of  stays on, it means successful connection.

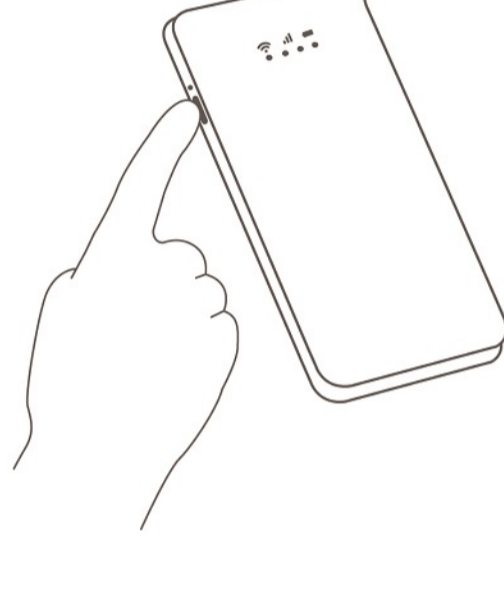

## 4 Activate U2

- Open GlocalMe APP
- Press **My Device** → **Activate Device**
- Scan the device QR-code on the back of U2 (or inside)
- Re-start your U2 after activation success

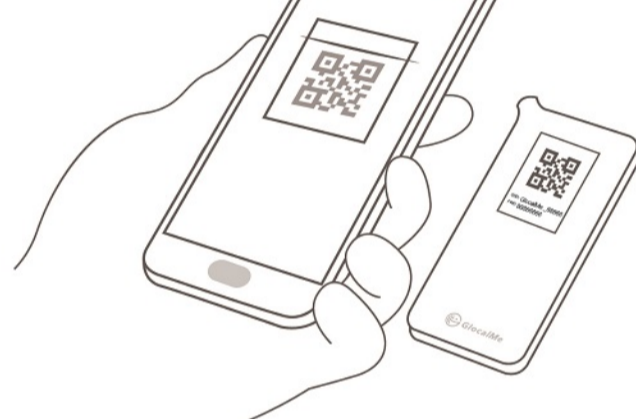

## 5 Connect the Wi-Fi

- Find the Wi-Fi name and password at the back of U2 (or inside)
- Connect your mobile device in Wi-Fi setting

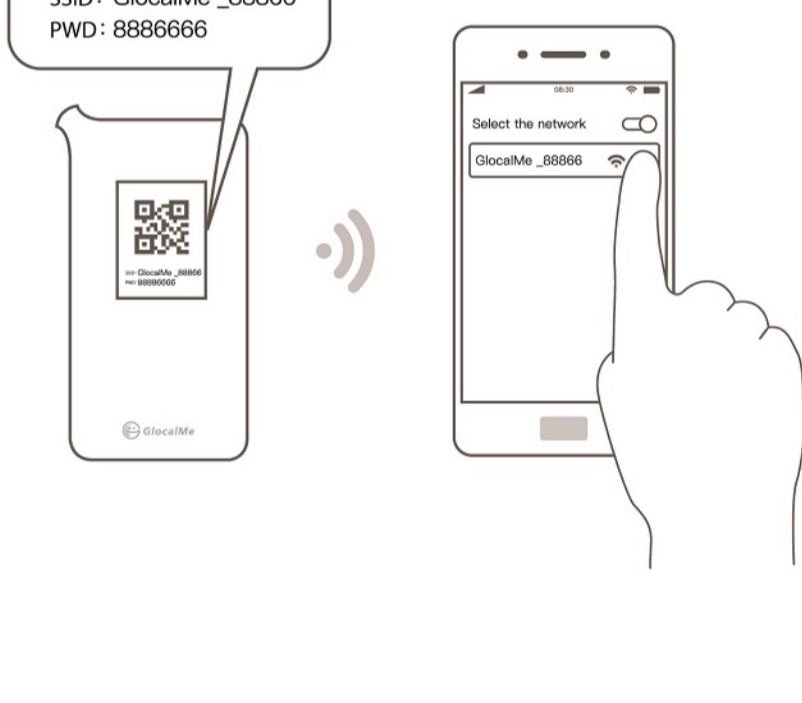

## U2 Light Indicator:

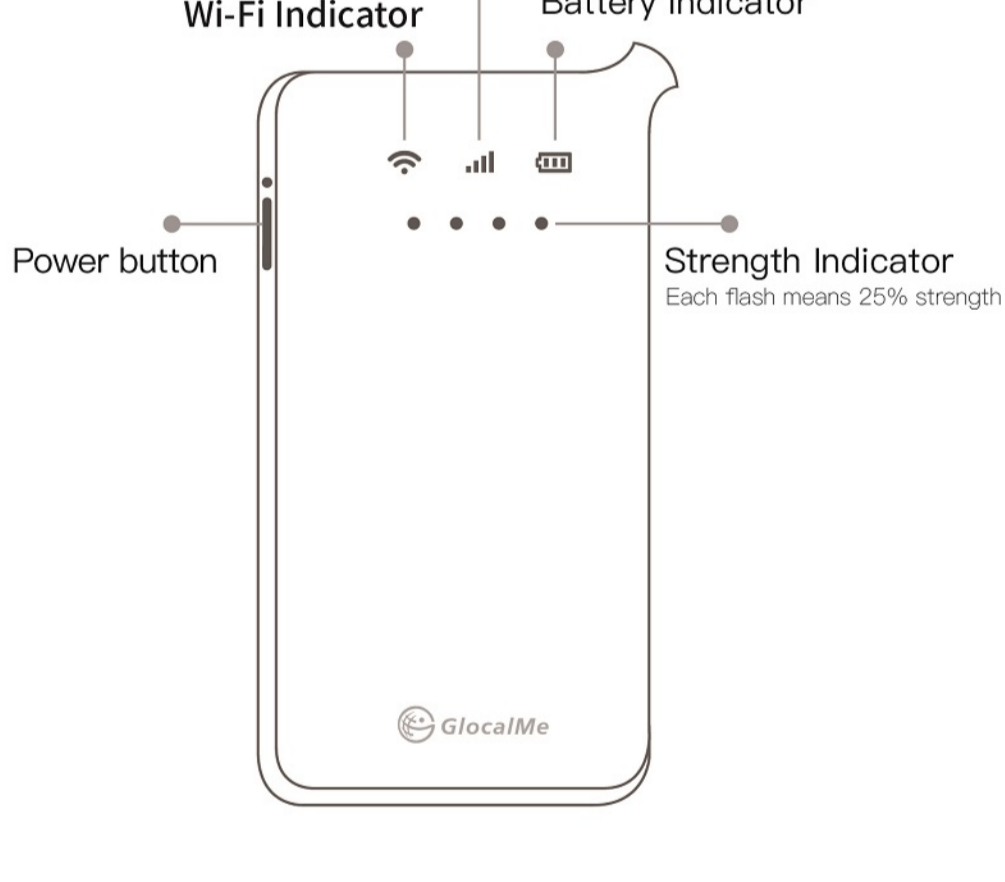

## 1 Battery Check

Press Power button once for checking the battery level

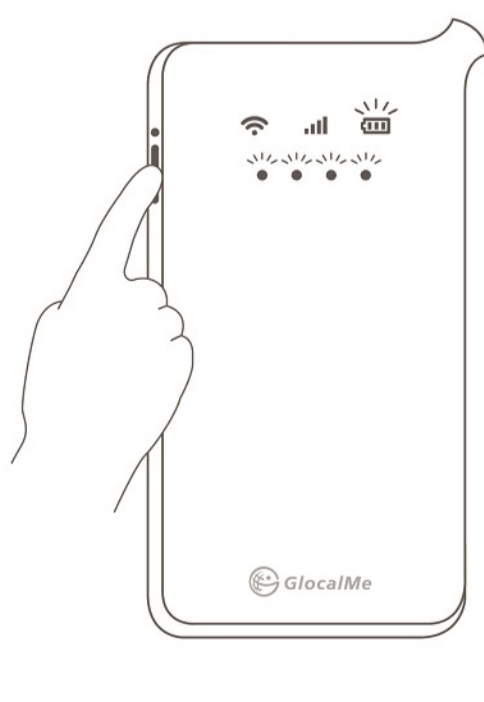

## 2 Signal Check

Press Power button twice for checking the signal strength

